

LEGEND:

- INDICATES DWELLING UNIT (100') (TYPE 1)
- INDICATES DWELLING UNIT (80') (TYPE 2)
- INDICATES PROPOSED STORMWATER MANAGEMENT AREA
- INDICATES FOCAL POINT (PUBLIC) (INCLUDES RECREATION AREA)
- INDICATES AMENITIES AREA (PRIVATE)
- INDICATES AREA NOT INCLUDED IN THIS PETITION
- INDICATES GREENWAY AREA
- INDICATES GREENWAY EXPANSION AREA
- INDICATES EXISTING WETLAND
- INDICATES 400 AC. (DEVELOPMENT AREA BOUNDARY)
- INDICATES 500' GREENBELT

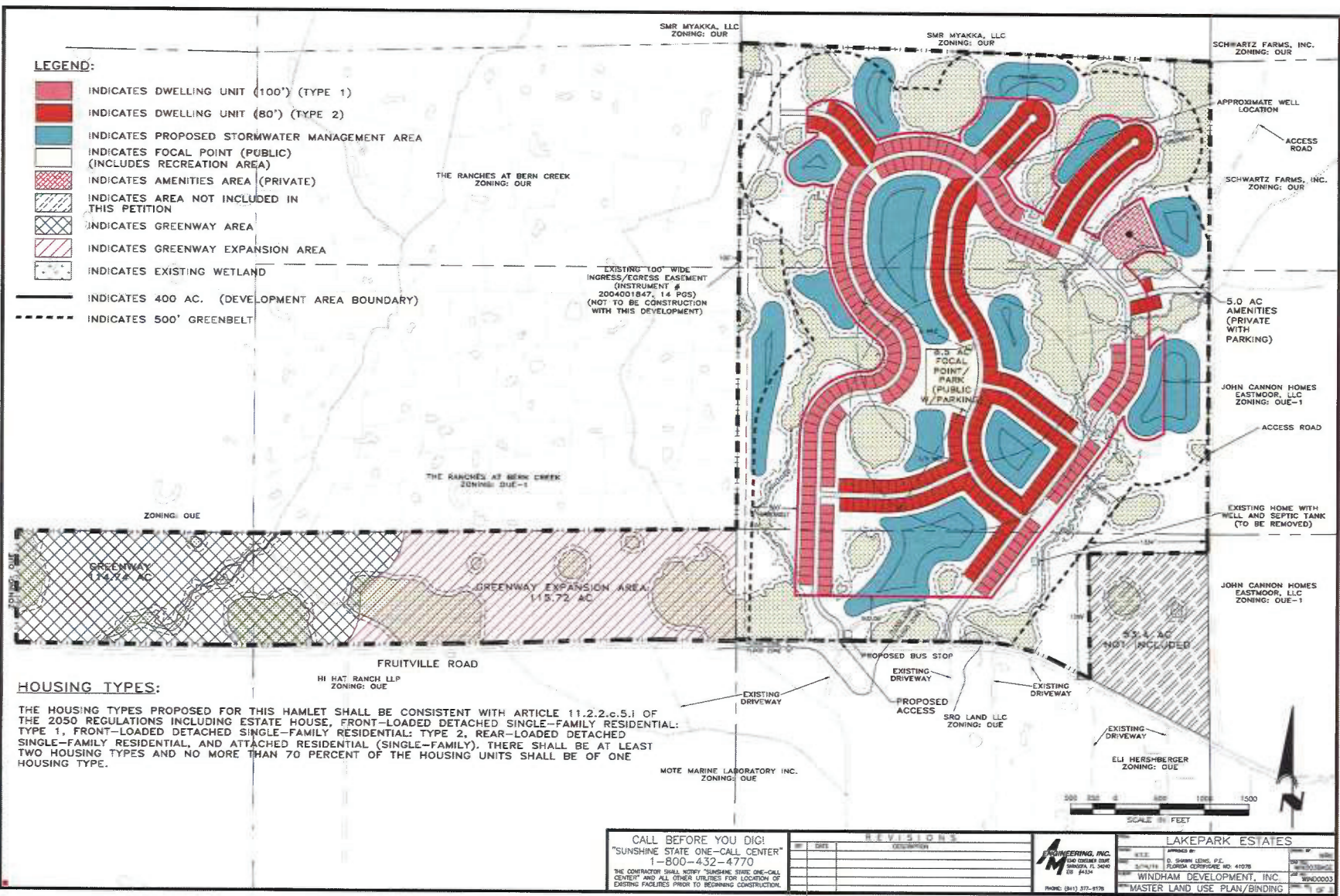

HOUSING TYPES:

THE HOUSING TYPES PROPOSED FOR THIS HAMLET SHALL BE CONSISTENT WITH ARTICLE 11.2.2.c.5.i OF THE 2050 REGULATIONS INCLUDING ESTATE HOUSE, FRONT-LOADED DETACHED SINGLE-FAMILY RESIDENTIAL: TYPE 1, FRONT-LOADED DETACHED SINGLE-FAMILY RESIDENTIAL: TYPE 2, REAR-LOADED DETACHED SINGLE-FAMILY RESIDENTIAL, AND ATTACHED RESIDENTIAL (SINGLE-FAMILY). THERE SHALL BE AT LEAST TWO HOUSING TYPES AND NO MORE THAN 70 PERCENT OF THE HOUSING UNITS SHALL BE OF ONE HOUSING TYPE.

CALL BEFORE YOU DIG!
 "SUNSHINE STATE ONE-CALL CENTER"
 1-800-432-4770
 THE CONTRACTOR SHALL NOTIFY "SUNSHINE STATE ONE-CALL CENTER" AND ALL OTHER UTILITIES FOR LOCATION OF EXISTING FACILITIES PRIOR TO BEGINNING CONSTRUCTION.

NO.	DATE	REVISIONS

ENGINEERING, INC.
 2100 COLLETT DRIVE
 MIAMI, FL 33146
 PHONE: (305) 377-8178

LAKEPARK ESTATES
 APPROVED BY:
 D. SHAWN LEUNG, P.E.
 FLORIDA CERTIFICATE NO. 41078
WINDHAM DEVELOPMENT, INC.
 WIND00003
 MASTER LAND USE PLAN/BINDING

Rec'd by Planning Services
 May 29, 2014